

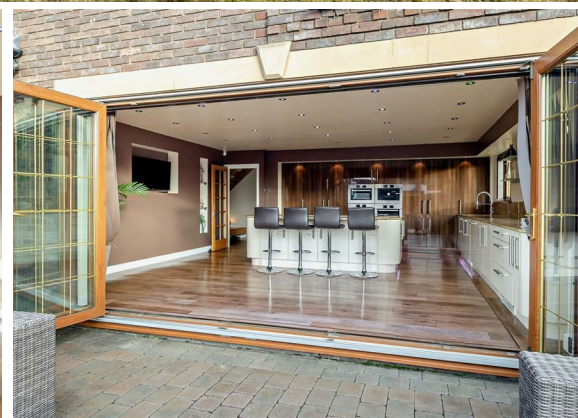

5 Bed  
House -  
Detached  
located in  
Armthorpe

Offers In The Region Of  
£545,000



**Moss**  
PROPERTIES



DIRECTIONS

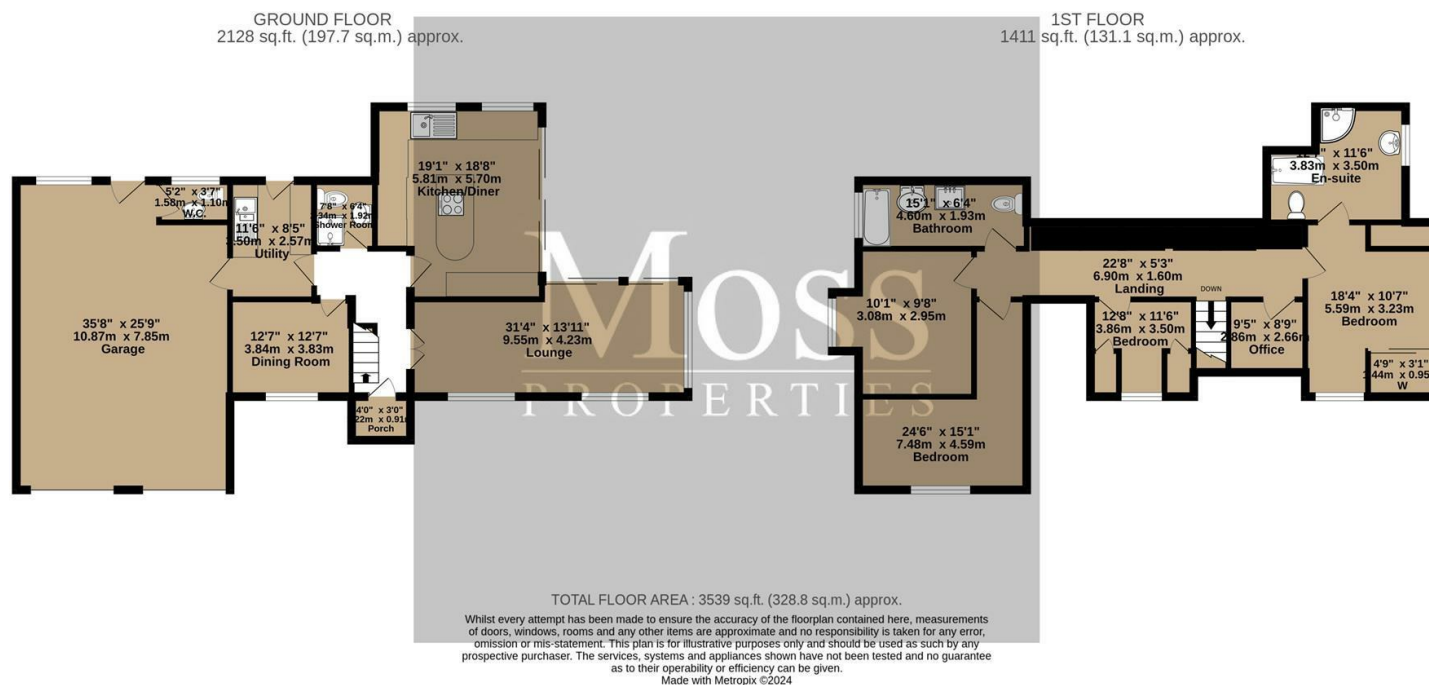

CONTACT

White Rose Way  
Doncaster  
South Yorkshire

E: [leads@mossrpm.co.uk](mailto:leads@mossrpm.co.uk)  
T: 01302 730077  
[www.mossrpm.co.uk](http://www.mossrpm.co.uk)

Energy Efficiency Rating		
	Current	Potential
Very energy efficient - lower running costs		
(92 plus) A		
(81-91) B		
(69-80) C		
(55-68) D		
(39-54) E		
(21-38) F		
(1-20) G		
Not energy efficient - higher running costs		
England & Wales		EU Directive 2002/91/EC

Moss  
PROPERTIES